



Expand your possibilities

a[®]dec
reliablecreativesolutions™





Why choose A-dec

We've been partnering with doctors for over 45 years to produce reliable, creative dental solutions. Here are just a few of the reasons why so many dental professionals continue to choose A-dec.

Quality and reliability. We have a reputation for creating the most durable and reliable dental equipment. This is due largely to our dedication to quality plus our focus on simple design, which results in robust equipment that requires minimal maintenance.

Ergonomics and efficiency. A-dec offers a wide choice of equipment. No matter how you and your team work, we have solutions that maximise ergonomics and increase efficiency.

Functionality and expandability. A-dec equipment seamlessly integrates many ancillary devices you control via touchpad and/or foot control. This saves time and reduces clutter. The sophisticated platform design supports future upgrades and expansion.

Comfort and style. Through the science of pressure mapping, A-dec engineers increased chair comfort by reducing pressure points and streamlining support across the entire body.



The nurse is cleaning and lubricating used (contaminated) handpieces.



Push-to-open drawers enable easy access. Here, the nurse is placing a cassette into a soaking drawer.



The conveniently placed dryer eliminates unnecessary touch points.

Sterilisation Solutions

An integral part of running an efficient and productive dental practice is your infection control system. The four-phase system uses designated areas, from reception of used instruments to sterilisation and storage — a process designed to reduce the risks of cross-contamination.

Four-phase system includes:

1. Receiving and cleaning
2. Rinsing, preparation, and packaging
3. Sterilisation
4. Storage



Contained under the single countertop, the nurse is able to wrap the cassette for sterilisation.



With a well-designed system, movement of items requires very little reaching or twisting. Here, the cassette is placed into the steriliser.



Once the instruments are sterilised, they are placed in a securely sealed cabinet system.



Add efficient functionality by minimizing touch points and streamlining workflow from treatment room to sterilisation centre and back to the treatment room.

Protective Design Features

Create an environment that gets the most of your space. Through thoughtful design, your staff is able to collect and replace materials without disturbing procedures.

Shown is A-dec Preference ICC®, a system designed with foot/knee activated doors, waterproof shelves, optional hands-free dryer, and motion-activated soap dispensers to maintain a sterile environment with streamlined processes, procedures and storage.

This system is designed to work in conjunction with procedure tubs for materials management and an efficient tray or cassette system, as well as cabinetry that supports them.



Materials Management

A materials management system works in harmony with the A-dec 12-o'clock treatment console. The optional upper storage area for prepared tubs, used tubs and instrument trays or cassettes allows the nurse to transfer materials from the treatment console to the circular work surface ready for use.

Your instrument delivery should allow you to operate comfortably and efficiently while increasing the productivity of the entire dental team. Experts who study dental ergonomics have proven how persistent pain in the lower back, neck, shoulders, wrists and hands is due to the equipment's inability to accommodate nurses working in a 4-handed practice.

Overcoming repetitive strain is precisely why A-dec designed and created the 545 and the 541 delivery systems. A-dec solutions support and position the nurse at the heart of the treatment room. These cabinet-mounted delivery systems, being height-adjustable and rotational, position the instruments within the nurse's reach. The nurse can pass the instruments to the dentist thereby increasing the speed of procedures and eliminating debilitating bending and twisting.



Think Differently

Why not consider materials management from a different angle? The procedure tub provides a simple solution for storing consumable materials and transporting items from the sterilisation area to the treatment room and back again.

Materials needed during a planned procedure are loaded directly in a central storage area and delivered from the tub to the user, keeping your procedure tray free for instrumentation. At the end of the day, materials are replenished and the tub is stored for future use.

The colour coding system allows one tub for each procedure. Using a variety of components, you can customise the tub to your preferences.



Dependable solutions designed for you

Whether you're looking to upgrade your delivery system or remodel your entire practice, there's an A-dec solution designed to meet your current needs with the ability to easily upgrade as your practice grows and your needs change.

Comfort-engineered chairs. Delivery systems with true integration. Lightweight handpieces and motors. Cabinetry that streamlines workflow. Discover proven solutions that expand your possibilities.



A-dec 500® is an elegant display of innovation for dentists who prefer style, expect ergonomic efficiencies, and seek a solution that optimises comfort for everyone inside the treatment room.

Did You Know?

You can choose your
own design!

See the interactive
colour tool at
a-dec.color.com.



The robust design of the A-dec 300 system provides fewer parts to maintain, fewer parts to replace, and less to clean. And yet there's no compromise in comfort or lack of options to accommodate how you work.



solution one

Featured Equipment

- A-dec 511 Chair (*custom upholstery color; Sorbet, special fees apply*)
- A-dec 532 Traditional Delivery System
- A-dec 545 Nurse's Unit
- A-dec 561 Cuspidor and Support Center
- A-dec 1601 Doctor's Stool with ergonomic tilt
- Preference Collection 5580.42 Treatment Console with solid surface countertop
- Preference Collection 5531.58 Accessory Console

Configuration Benefits

- Increased productivity with the rear treatment console, which allows an efficient flow of materials and instruments into and out of the treatment room
- Extensive range of motion and positioning with A-dec 545 nurse's unit allowing full ambidextrous use
- Maximum storage for minimally spaced treatment rooms, allows for ease of dispensing materials and instruments
- Treatment console to provide space efficiency for almost any room size
- Would suit wall-, chair- or ceiling- mounted operating light

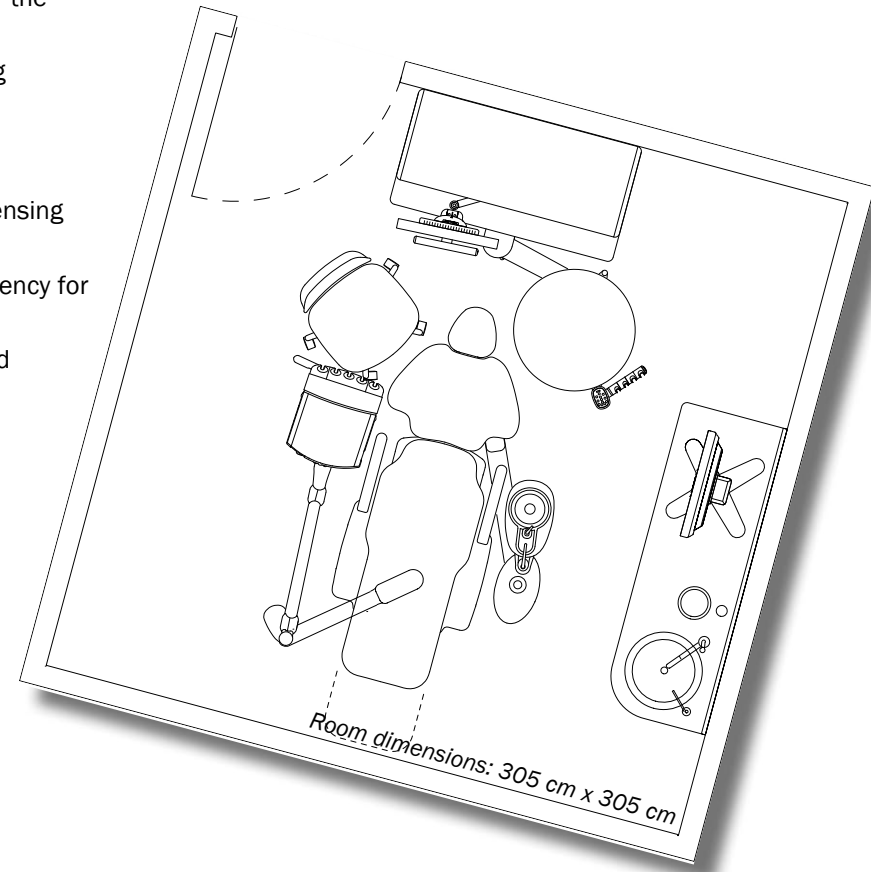



solution two

Featured Equipment

- A-dec 311 Chair with double-articulating headrest
- A-dec 334 Traditional Delivery System
- A-dec 352 3-position telescoping Nurse's Unit
- A-dec 361 Support Center
- A-dec 571-300 Dental Light
- Preference Collection 5580.42 Treatment Console with solid surface countertop
- Preference Collection 5631.58 Accessory Console

Configuration Benefits

- A-dec 300 offers a robust design, great access, and minimal maintenance at a value price
- Ample storage space for supplies and equipment in a compact, 2-handed treatment room
- Everything you need to comfortably perform general restorative dentistry

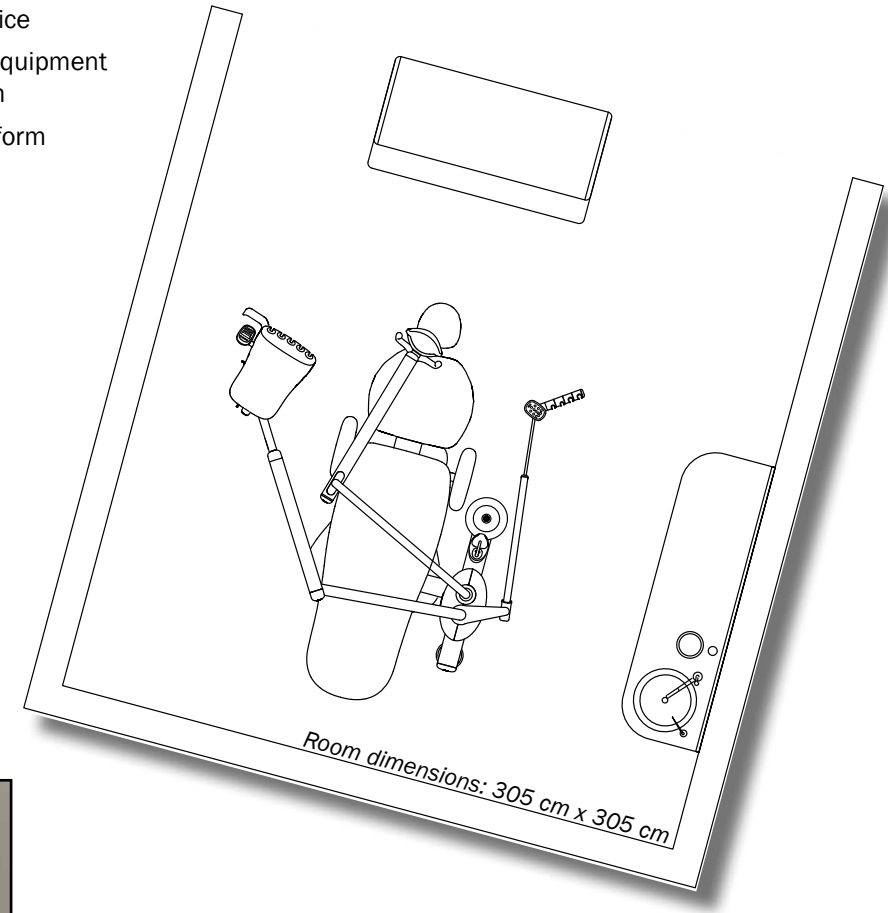



solution three

Featured Equipment

- A-dec 511 Chair
- A-dec 533 Continental Delivery System
- Preference Collection 5580.42 Treatment Console with solid surface countertop
- Preference Collection 5531.58
(2) Accessory Consoles

Configuration Benefits

- The A-dec 500 chair is designed to position low enough so any doctor, regardless of height, can work in complete comfort
- Supple sewn upholstery to enhance the richness to the operator
- Left/right compatibility to ensure long-term adaptability

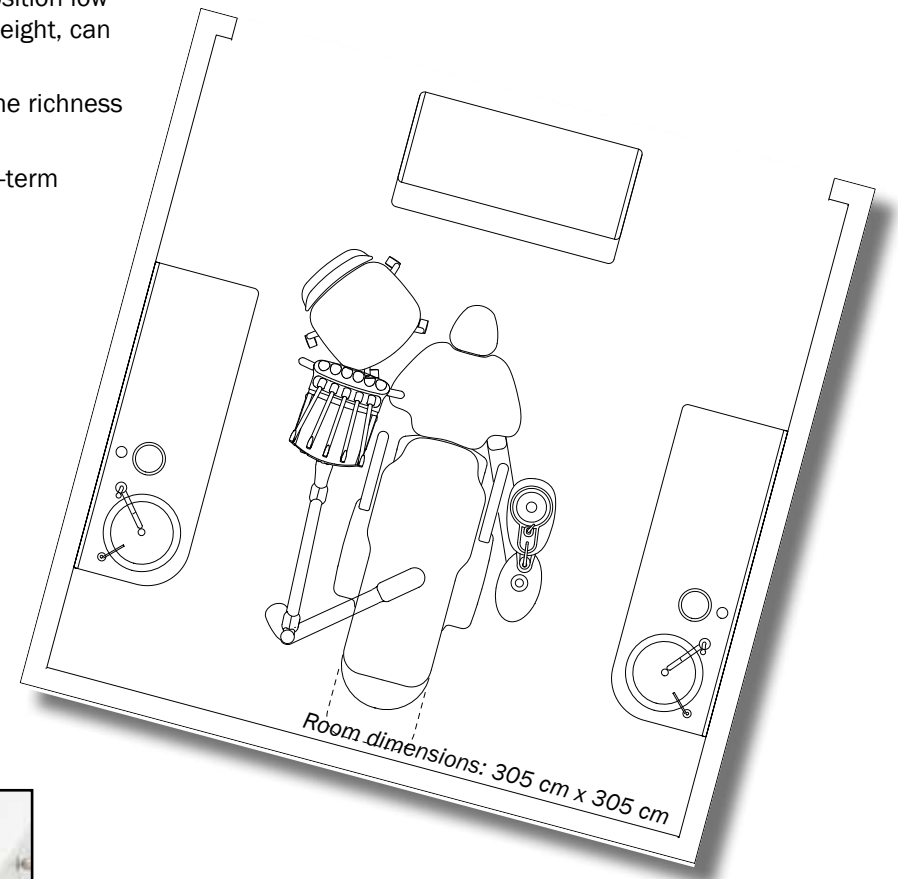



solution four

Featured Equipment

- A-dec 311 Chair with patient-adjustable neck support
- A-dec 334 Traditional Delivery System
- A-dec 352 3-position telescoping Nurse's Unit
- A-dec 361 Support Center with Monitor Mount
- A-dec 571-300 Dental Light
- A-dec 1601 Doctor's Stool with ergonomic tilt
- Preference Collection 5580.69 Treatment Console with solid surface countertop

Configuration Benefits

- Positioning of both the vacuum and delivery system instruments offers easy access creating an ideal set up for hygiene
- The 175 cm wide Preference Collection 5580 treatment console with wash station provides plenty of storage options for equipment and supplies
- A track-mounted monitor on the treatment console creates an exceptional solution for patient record keeping

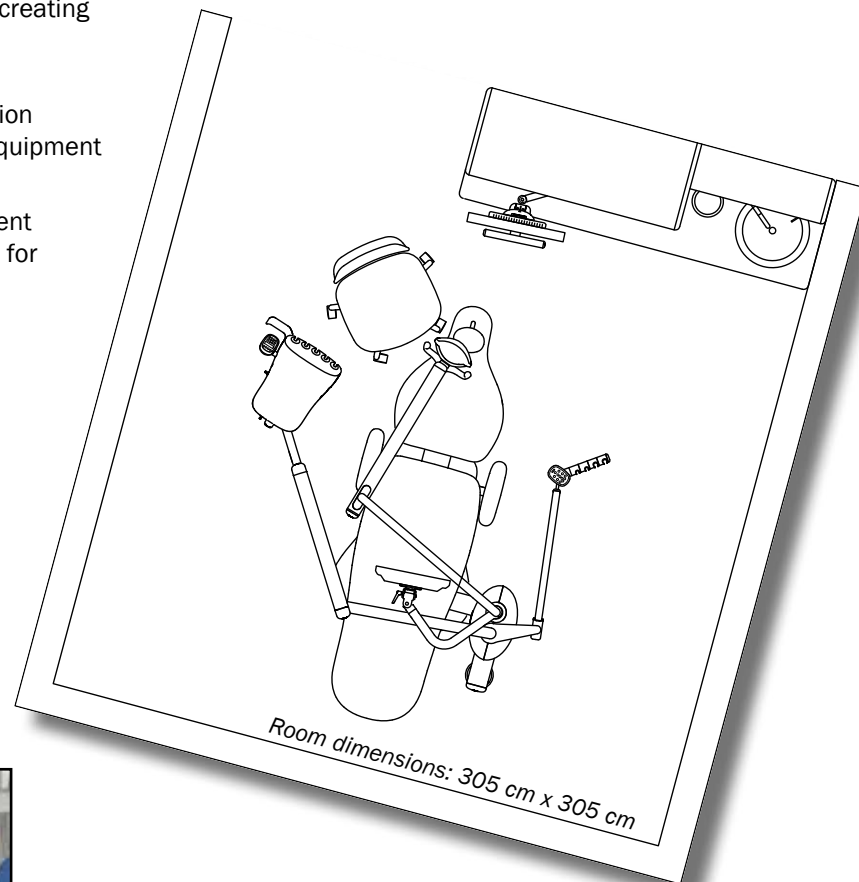



solution five

Featured Equipment

- A-dec 311 Chair with double-articulating headrest
- A-dec 334 Traditional Delivery System
- A-dec 545 Nurse's Unit
- A-dec 1601 Doctor's Stool with ergonomic tilt
- Preference Collection 5580.42 Treatment Console with solid surface countertop
- Preference Collection 5531.58 Accessory Console

Configuration Benefits

- The perfect blend of style and function of the A-dec 311 chair is sure to make a favorable impression with patients
- Extensive range of motion and unsurpassed positioning with a nurse's unit that allows full ambidextrous use
- The simple and clean design provides an uncluttered layout

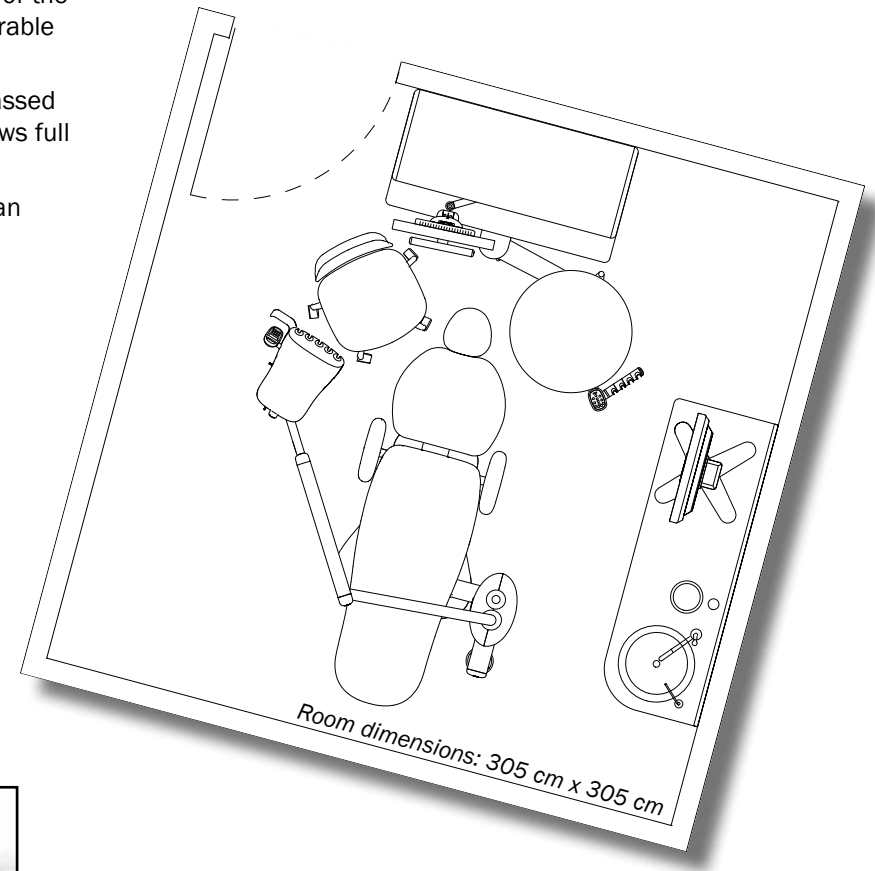



solution six

Featured Equipment

- A-dec 511 Chair with sewn upholstery
- A-dec 541 12-o'clock Duo Delivery System
- A-dec 6300 Track-Mount Dental Light
- A-dec 531 Monitor Mount
- A-dec 561 Cuspidor and Support Center
- A-dec 1601 Doctor's Stool with ergonomic tilt
- A-dec 1622 Assistant's Stool
- Preference Collection 5580.42 Treatment Console (base only)
- Preference Collection 5531.72 (2) Accessory Consoles
- Preference Collection 5731.34 (2) Upper Storage Units
- Preference Collection 5730.29 (2) Dispensing Units



Configuration Benefits

- Get extensive range of motion and unsurpassed positioning with the A-dec 500 12-o'clock delivery system
- The A-dec 500 12-o'clock nurse's unit features four pivot points and a round, height-adjustable worksurface that adds up to exceptional range of motion
- With equipment out of the patients' direct view and the monitor mounted on the chair, this configuration provides an optimal setting for patient education and treatment plan acceptance

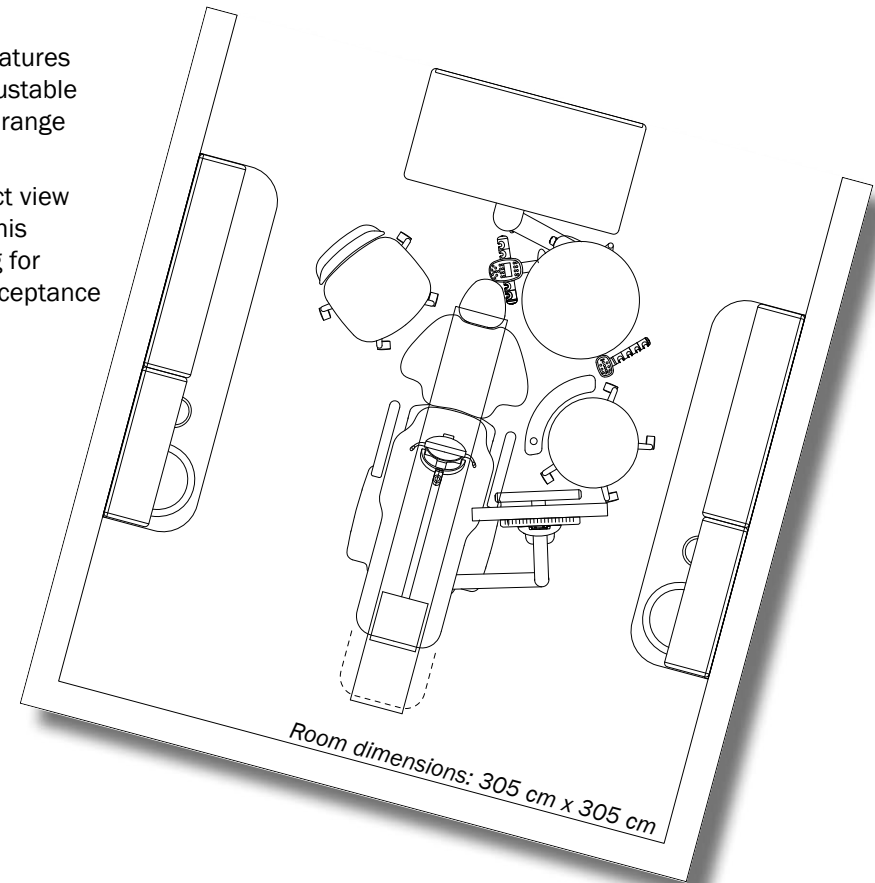



solution seven

Featured Equipment

- A-dec 311 Chair with double-articulating headrest
- A-dec 334 Traditional Delivery System
- A-dec 545 Nurse's Unit
- 361 Cuspidor and Support Center
- A-dec 1601 Doctor's Stool with ergonomic tilt
- Preference Collection 5580.42 Treatment Console with solid surface countertop
- Preference Collection 5531.58 Accessory Console

Configuration Benefits

- Increase productivity when you combine the A-dec 334 traditional delivery system with the treatment console
- The versatile motion of the A-dec 545 nurse's unit and round worksurface enables the nurse to do more within less space
- The two monitor mount locations are ideally suited for multiple purposes, from patient consultations and education to practice management

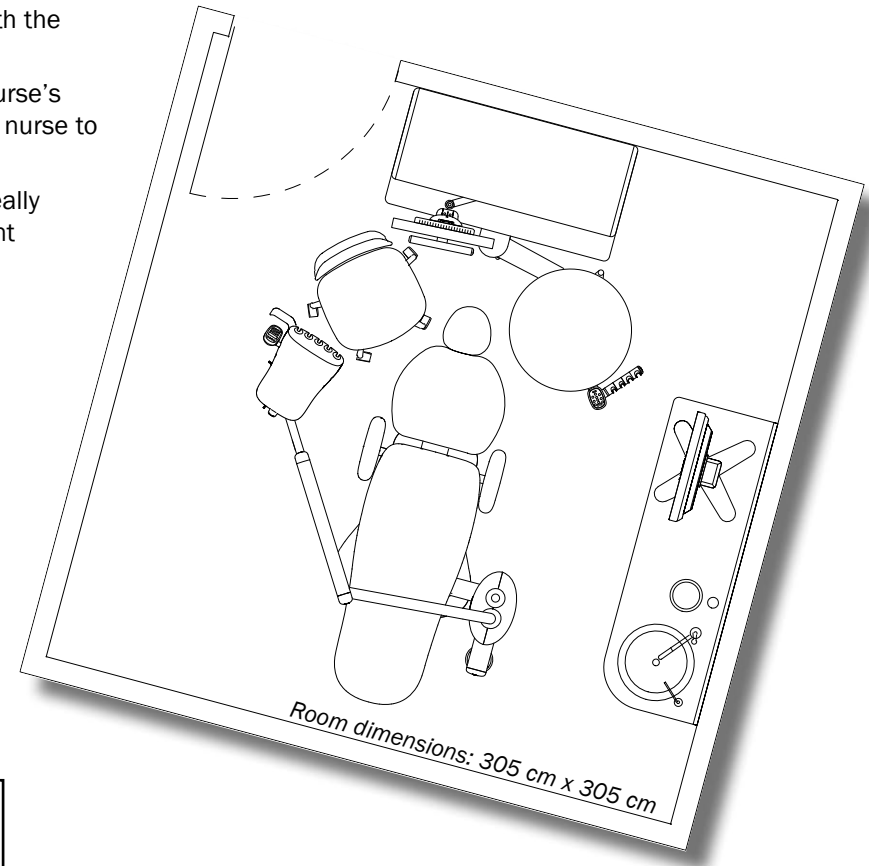



solution eight

Featured Equipment

- A-dec 511 Chair with sewn upholstery
- A-dec 542 Side Delivery System
- A-dec 545 Nurse's Unit
- A-dec 561 Support Center, Cuspidor
- Ceiling-mount Monitor Mount
- A-dec 571 Dental Light
- A-dec 1601 Doctor's Stool with ergonomic tilt
- A-dec 1622 Assistant's Stool
- Preference Collection 5580.42 Treatment Console with solid surface countertop
- Preference Collection 5531.72 Accessory Console
- Preference Collection 5731.34 Upper Storage Unit
- Preference Collection 5730.29 Dispensing Unit



Configuration Benefits

- For the ultimate in patient comfort, the A-dec 500 chair with sewn upholstery reduces pressure points and provides support across the patient's entire body
- Put your patients at ease with the A-dec 500 side delivery system that easily tucks away so it's out of the patients' direct view when they enter the room—it's also an excellent solution for narrow treatment rooms
- Customise instrument positioning for increased efficiency with the A-dec 500 long-arm nurse's unit

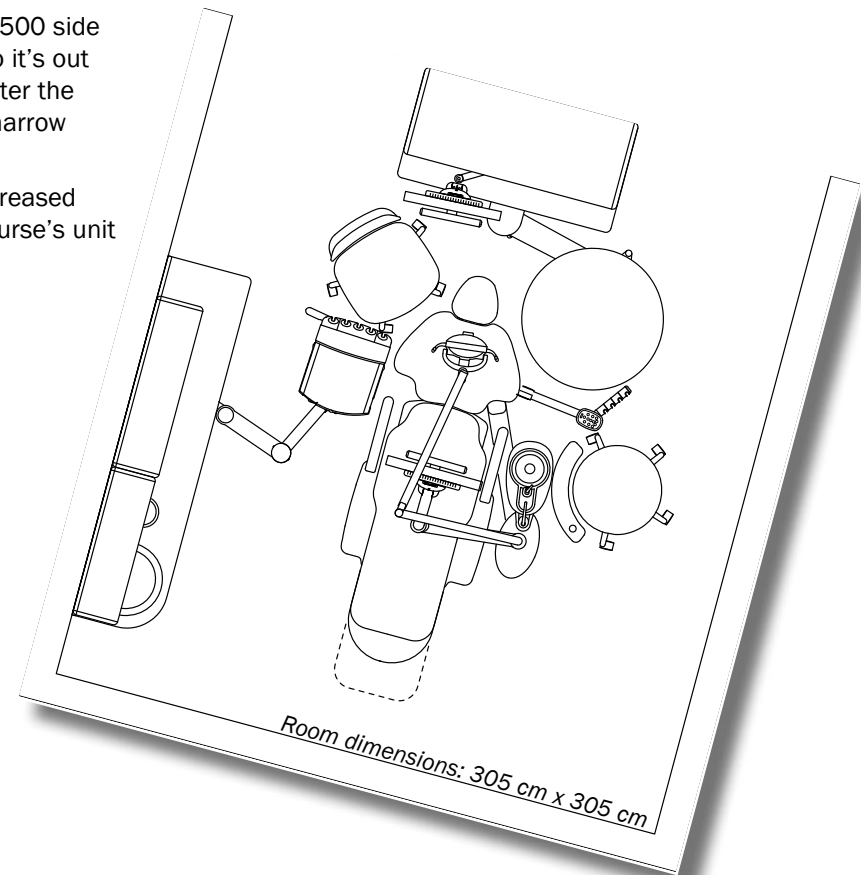



solution nine

Featured Equipment

- Performer Chair
- Performer Traditional Delivery System
- Performer Cuspidor with nurse's unit
- 6300 Post-mount Light
- A-dec 1601 Doctor's Stool with ergonomic tilt
- A-dec 1622 Assistant's Stool
- Preference Collection 5580.42 Treatment Console with solid surface countertop
- Preference Collection 5543 Central Console

Configuration Benefits

- Light, cuspidor, and delivery are configured for optimal two-handed dentistry
- The performance of the Performer chair never compromises patient comfort
- Tall central cabinetry with round-end wash station and x-ray storage creates a wall while accommodating supplies and maximising space

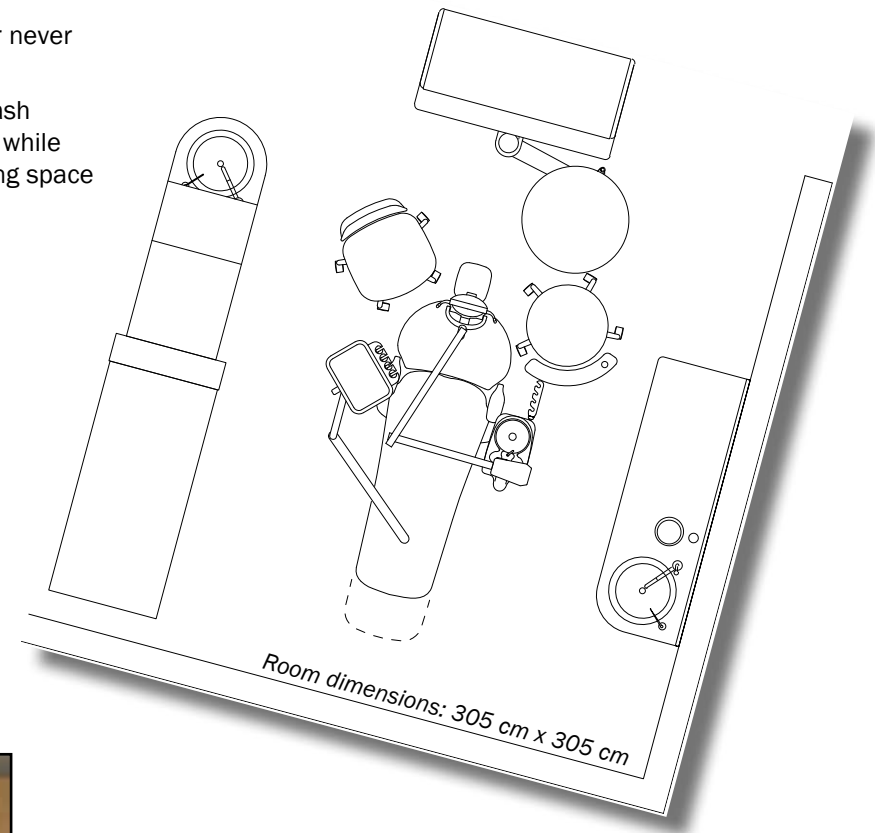



solution ten

Featured Equipment

- A-dec 311 Chair with double-articulating headrest
- A-dec 334 Traditional Delivery System
- A-dec 361 Cuspidor and Support Center
- A-dec 545 Nurse's Unit
- A-dec 1601 Doctor's Stool with ergonomic tilt
- Preference Collection 5580.42 Treatment Console (base only) with solid surface countertop
- Preference Collection 5531.58 Accessory Console

Configuration Benefits

- A-dec 300 offers a robust design, great access, and minimal maintenance at a value price
- Everything you need to comfortably perform general dentistry
- Extensive range of motion and unsurpassed positioning with A-dec 545 nurse's unit
- Allows for versatile ambidextrous functionality within limited space

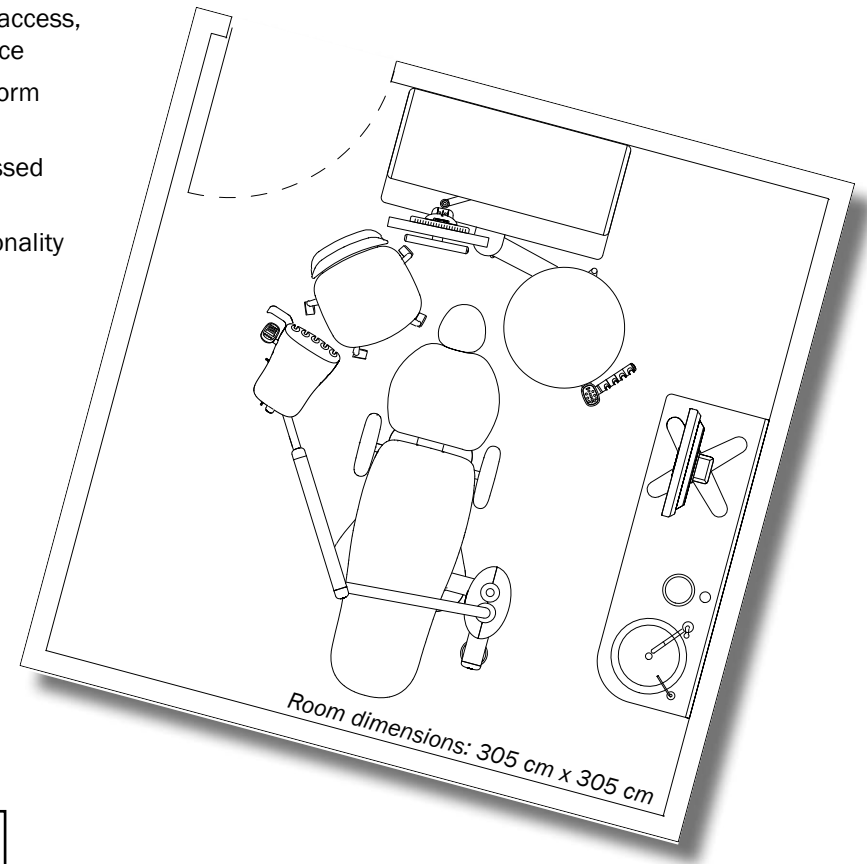

Explore the possibilities

Make your next treatment room your own. We invite you to see how your personal colour preferences would appear on your choice of cabinets, countertops, chair upholstery, and more.

Go to a-dec-color.com to explore the full spectrum of possibilities.

We want to hear from you. To find an A-dec dealer near you, call us at 1.800.547.1883 or visit a-dec.com.



World Headquarters

2601 Crestview Drive

Newberg, Oregon 97132 USA

Tel: 1.800.547.1883 Within USA/Canada

1.503.538.7478 Outside USA/Canada

Fax: 1.503.538.0276

a-dec.com

International Distribution Centers

A-dec Australia

Tel: 1.800.225.010 Within Australia

Tel: + 61 (0)2 8332 4000 Outside Australia

a-dec.com.au

A-dec United Kingdom

Tel: 0800 ADECUK (233285) Within UK

Tel: +44 (0) 24 7635 0901 Outside UK

a-dec.co.uk

A-dec, A-dec logo, A-dec 300, A-dec 500, Continental, Decade, Radius, ICV, Preference, Preference Collection, and Preference ICC are registered trademarks in the U.S. Patent and Trademark Office.

All other products or services mentioned in this document are covered by the trademarks, service marks, or product names as designated by the companies that market those products. Touchpad symbols are proprietary to A-dec Inc.

The colours and products shown may vary from the actual materials and are subject to change without notice. Please see your authorized A-dec dealer for accurate colour samples and the most current product information.

©2010 A-dec Inc. All rights reserved. 85.0068.00/08-10/Rev A